

GOLD DOME
P990004

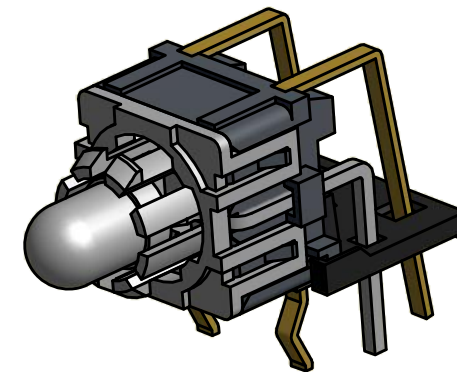

LED SPECS	UNITS	WHITE
FORWARD CURRENT	mA	20
FORWARD VOLTAGE @20mA	V	3.3-4.0
LUMINOUS INTENSITY @ 20mA	mcd	1200

OBSOLETE

January 2018

PCR 23186

NOTES:

1. ALL DIMENSIONS IN MM [INCH]
2. GENERAL TOLERANCE: X.X=±0.4
X.XX=±0.25
3. RATING: 50mA @ 12VDC
4. CONTACT RESISTANCE: 100mΩ MAX.
5. INSULATION RESISTANCE: 100MΩ MIN.
6. OPERATING FORCE: 280 ± 70gf
7. TRAVEL: 0.25 ± 0.15mm
8. OPERATING TEMPERATURE: -20°C TO 70°C
9. OPERATING LIFE: 50,000 CYCLES
- ▲ 10. LED: WHITE
- ▲ 11. CONTACTS: GOLD.
12. ▲ DENOTES CRITICAL PARAMETERS
13. 2011/65/EU (ROHS) COMPLIANT
14. PARTS TO BE PACKAGED IN TRAYS,
100 PIECES PER TRAY.

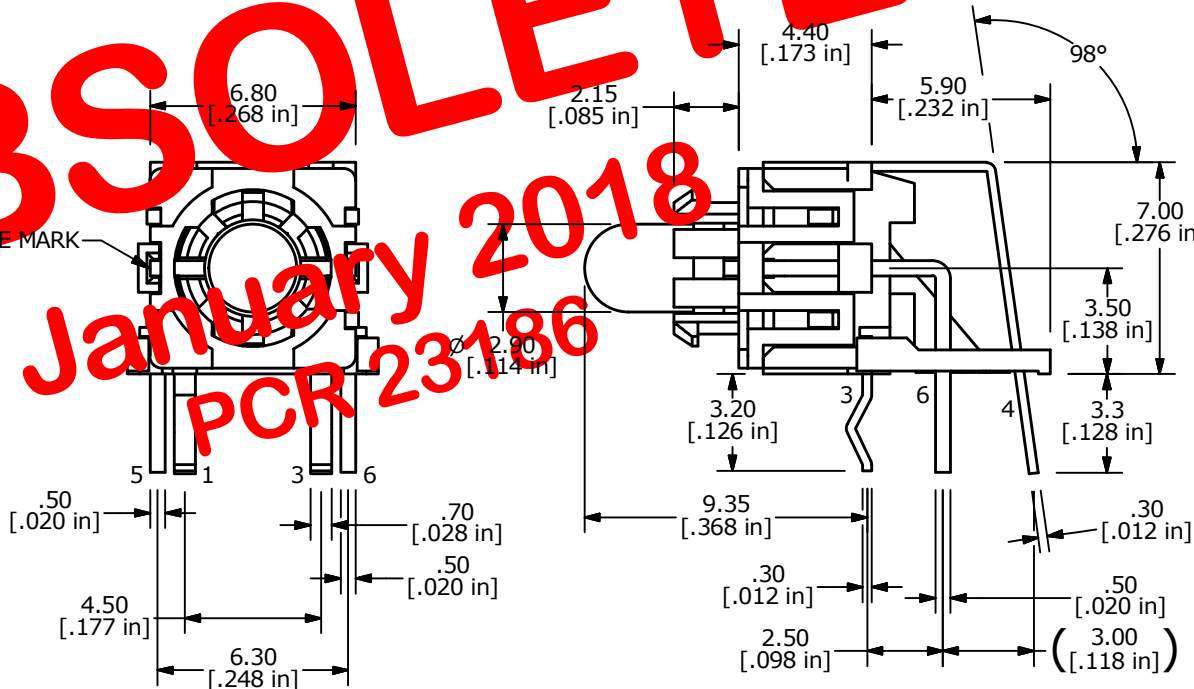

C	20260	ADD CALL-OUT FOR GOLD DOME	11/04/11	BMA
REV	PCR NO	DESCRIPTION	DATE	BY

TITLE	TL1250F280WRN			
SCALE	DATE	DR	DWG	REV
4:1	10/28/2011	BMA	P010824	C

THE INFORMATION CONTAINED IN THIS DOCUMENT IS PROPRIETARY TO E-SWITCH AND IS NOT TO BE COPIED OR TRANSFERRED